

AREAS	
NAME	AREA
LOT 43 - AREA	10344 SF
LOT 42 - AREA	2278 SF
LOT 41 - AREA	2278 SF
LOT 40 - AREA	2933 SF
LOT 43 - COVERAGE	1287 SF
LOT 42 - COVERAGE	1027 SF
LOT 41 - COVERAGE	1029 SF
LOT 40 - COVERAGE	1174 SF

FLOOR AREA (NO GARAGE)	
Name	Area
LOT 43 - LEVEL 3	656 SF
LOT 42 - LEVEL 1	656 SF
LOT 41 - LEVEL 1	656 SF
LOT 40 - LEVEL 1	601 SF
LOT 40 - LEVEL 2	814 SF
LOT 41 - LEVEL 2	795 SF
LOT 42 - LEVEL 2	795 SF
LOT 43 - LEVEL 2	795 SF

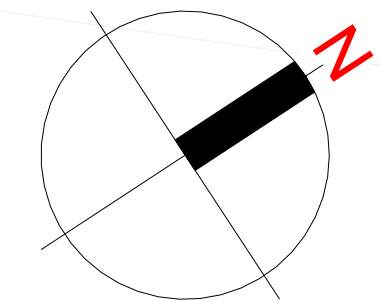

xx.xxM  
 DENOTES FINISHED GRADE

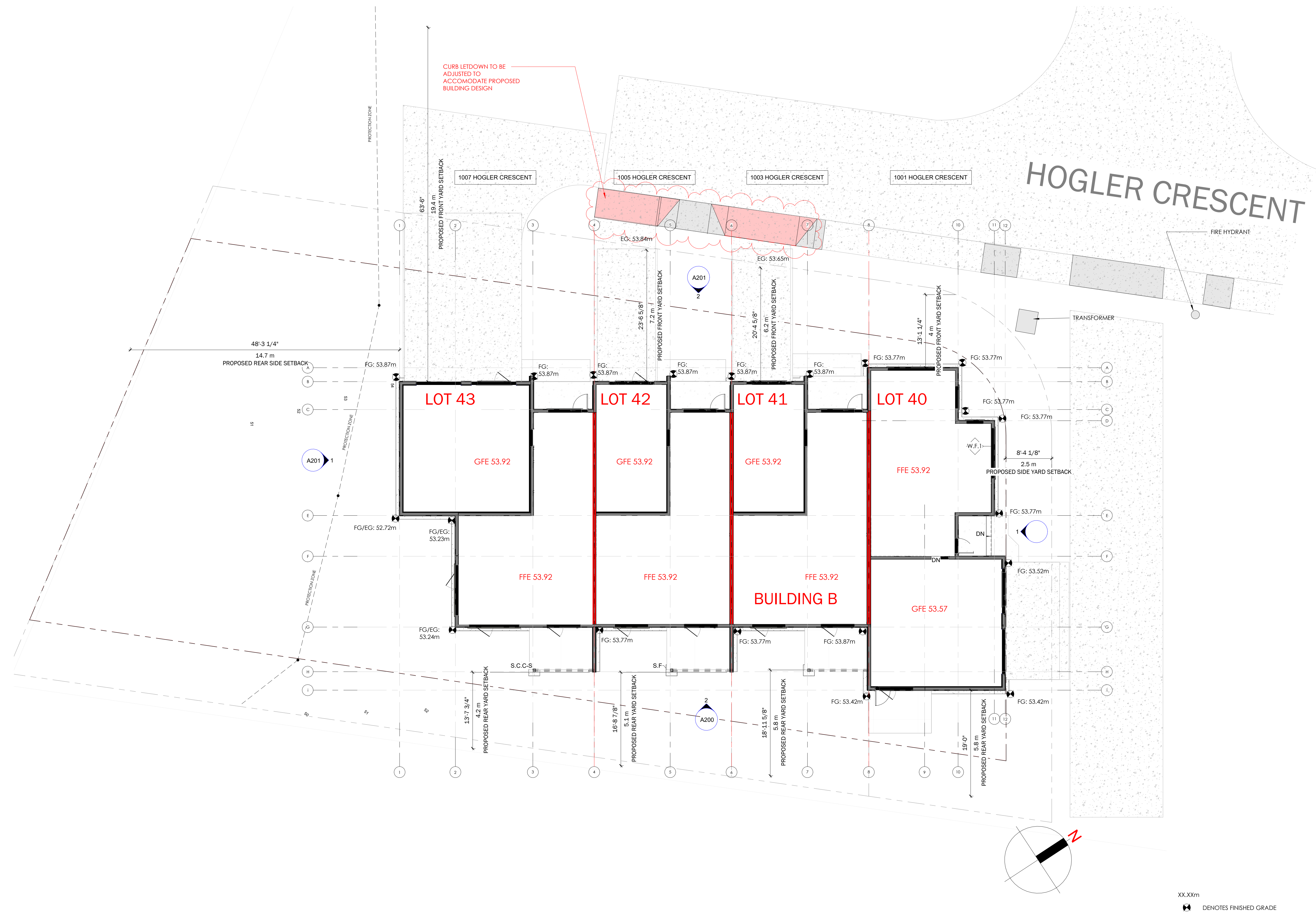
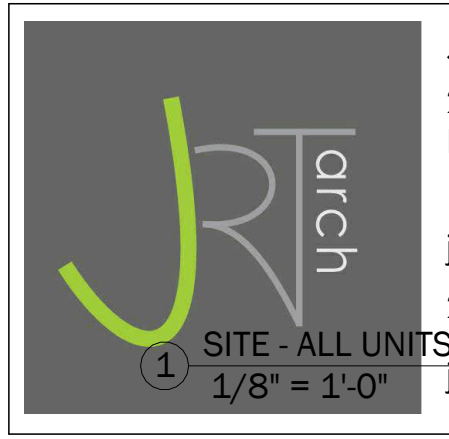

**JOYCE REID TROOST ARCHITECTURE**  
 2515 GLENAYR DRIVE  
 NANAIMO, BC V9S 3R9  
 joyce@jrtarchitecture.com  
 250.714.8749  
 jrtarchitecture.com

THE DRAWINGS, DESIGN IDEAS AND FEATURES OF CONTRIBUTION DEPICTED HEREIN ARE THE EXCLUSIVE PROPERTY OF JOYCE REID TROOST ARCHITECT. ALL COMMON COPY AND PROPERTY RIGHTS ARE EXPRESSLY RESERVED. THEY ARE NOT TO BE REPRODUCED, COPIED, REPRODUCED OR USED FOR ANY PURPOSES NOR ARE THEY TO BE ASSIGNED TO A THIRD PARTY WITHOUT EXPRESS WRITTEN CONSENT. IN THE EVENT OF ANY UNAUTHORIZED USE OF THESE PLANS BY A THIRD PARTY, THE THIRD PARTY SHALL NOT HOLD JOYCE REID TROOST ARCHITECT RESPONSIBLE.

ARCH. STAMP

**TOWNHOMES**  
 1001, 1003, 1005, 1007 Hogler Crescent  
 NANAIMO, BC

**RECEIVED**  
**DP1353**  
 2024-SEP-19  
 Current Planning

CLIENT  
 HOGLER ENTERPRISES

REV. DATE	NUMBER	DESCRIPTION
21.05.24	1	ISSUED FOR DP
02.08.24	3	REISSUED FOR DP

DATE  
 JUNE 15, 2022

SCALE  
 1/8" = 1'-0"

DRAWN: CC CHECKED: JRT APPROVED: JRT

SITE PLAN - BLDG. B

**A100**